



# Sunseeker Manhattan 70



## Yacht Information

Builder	Sunseeker Yachts
Model	Manhattan 70'
Year	2010
LengthOverall (m/ft)	22.31
Beam (m/ft)	5.67
Draft (m/ft)	1.7
Cabins	4
Crew	1
CruisingSpeed	25 Knots

## Price P.O.A.

Max Speed	34 kts
Fuel Capacity	4954 Lt
Engine(s)	Twin MAN
Power	1360 Hp
Generator(s)	20kw & 27kw Kohler
Stern Thruster	Yes
Bow Thruster	Yes
Air Conditioning	Tropical



Jones Bay wharf 19-21  
 Suite 90, 26-32 Pirrama road  
 Pyrmont NSW 2009

T: 02 9518 6977  
 F: 02 9571 4377  
 E: info@jwmarine.com.au

[www.jwmarine.com.au](http://www.jwmarine.com.au)



## Sunseeker Manhattan 70

*Non standard options fitted*

Raymarine Ray 240E Class D-DSC - VHF Dual station in lieu of standard

Raymarine Autopilot system ST8002+ dual station

Raymarine E120 -12.1" Colour Radar Chartplotter on lower console with E120 -12.1" Colour repeater on fly console & Raystar 125 GPS Diff receiver with 4kw 48" open scanner in lieu of std

Raymarine E120 -12.1" additional Colour display on the lower console

Raymarine ST60+ Speed and Depth system in lieu of Simrad IS20

Carbon fibre effect console panels

Two Sanshin Twin Beam remote controlled Searchlights HR-1012 dual station control in lieu of std

Air Conditioning - Tropical upgrade to chillers and air handlers including second shore power socket

Wine cooler Frigomar 456380 and additional Frigomar refrigerator fitted in the port side cabinet in the Lower Saloon

2.4 meter Whip Aerial for FM Radio to match VHF Aerial on Radar arch

Electric cooling unit for cool box on the Flybridge

Stern Docking Lights

Additional 3 under arch lights to the standard 3

Paint chain links every 10 metres as a calibration mark

Curved rear lounge seat with storage underneath - on the Flybridge

100m of 12mm anchor chain in lieu of standard

Raise pulpit rail 150mm and add additional safety wire along whole length

Rexroth Electronic portable engine and thruster controls with plug in extended lead

Dinghy Inflator & socket 12 volt

Low level Blue LED side deck lights 9 per side

Aqualuma white LED wide angle Series 6 white LED underwater lighting x 10 - 4 on Stern and 3 per side

Blue LED courtesy lights for the steps from the cockpit to the platform

Dimmer switches on interior lighting

2 x Bezenzoni Electric Helm seats in lieu of standard at the lower helm station

Rope lighting to be fitted under the port and starboard settee and under the step from Lower Saloon to dining

One reading light to be fitted on the forward bulkhead for Port side of double berth in the Crew Cabin

Alpine DVD/CD/MP3/Radio tuner DVA9861Ri linked to cabin TV with stereo cabin speakers in the Forward Cabin the Aft Master Cabin and in the Starboard Mid Cabin

Bose Lifestyle 48 DVD/CD Surround System in lieu of Standard Surround System in the Lower Saloon

Sharp 42" LCD television in lieu of the standard 32" in the Aft Master Cabin

Sharp 26" LCD television in lieu of standard in the Starboard Mid Cabin

Close Boarded Teak Flooring in the Dining, the Lower Saloon and in the Lobby

Teak Side Decks

Teak Decking on the Flybridge

Generator Upgraded to Kohler 27kw 50Hz in lieu of standard Kohler 20kw 50Hz

Second Generator - Kohler 20kw 50hz

Twin disc gearboxes

Additional pair 12" stern Mooring Cleats

Additional AC 220v single socket fitted in the stern locker above the platform extension cables

Additional AC 220v single socket fitted above the bar unit in the Aft Cockpit

Additional AC 220v single socket fitted in the wet bar locker on the Flybridge

Separate Washing machine and dryer in lieu of the port mid shower accessible from the lobby

Standard water tank in engine room to be converted into a fuel tank with transfer system to the main fuel tanks. New water tank to be fitted further forward under master stateroom/starboard cabin lobby floor in the Aft Master Cabin, in the Lobby

Sharp 20" LCD TV (fitted on the aft bulkhead and facing forward) and Alpine DVA9861Ri - CCTV camera linked to the TV in the Crew Cabin

Coolmatic Fridge with Freezer compartment (ice box) in lieu of the washer dryer in the Crew Cabin

Additional pair of Alpine Marine 2 way cockpit speakers SPS-M600 on the Flybridge

Whirlpool 25RI D4 fridge freezer Ptno. 472420 in lieu of standard in the Galley

Lewmar V6 anchor winch in lieu of standard

CCTV system with 1 camera in the aft cockpit, 2 cameras in engine room and 1 on bow roller. Linked to the Raymarine E series and the crew TV

Hydraulic Bow and Stern Thruster system upgrade Slepner Side-Power SP220 HYD with Simultaneous dual controls

Fresh water Deck wash with outlets fwd & aft including deck wash hose kit

General Ecology Nature Pure Ultrafine Water purifier for the Icemaker one filter for each unit



Jones Bay wharf 19-21  
Suite 90, 26-32 Pirrama road  
Pyrmont NSW 2009

T: 02 9518 6977  
F: 02 9571 4377  
E: info@jwmarine.com.au

[www.jwmarine.com.au](http://www.jwmarine.com.au)

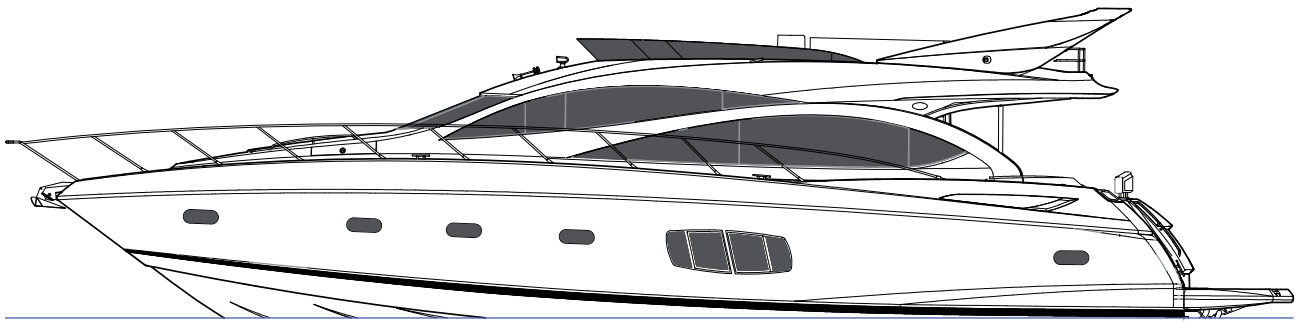

Profile

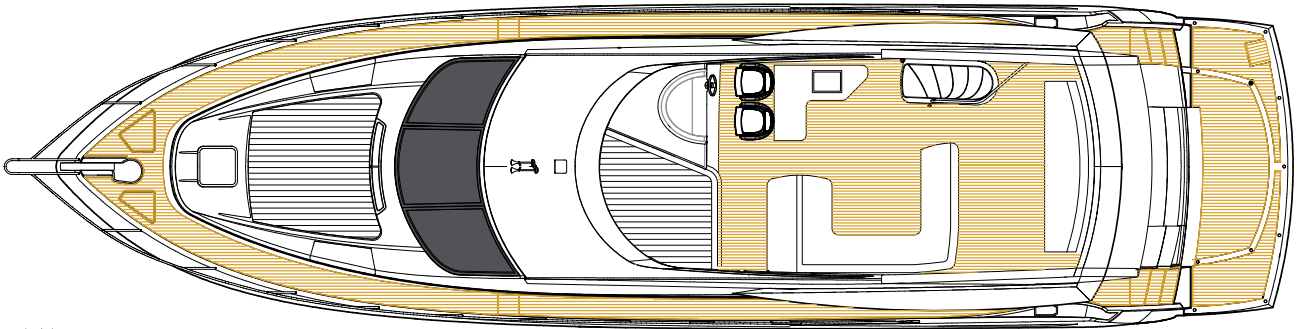

Flybridge

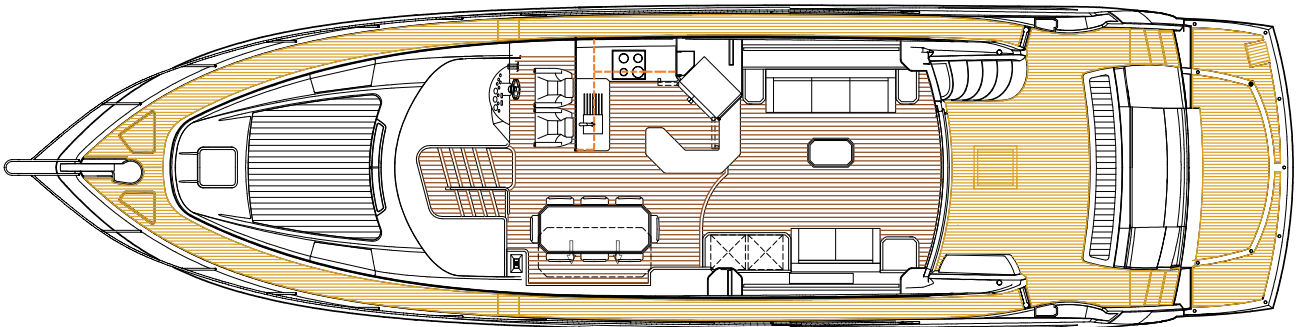

Main Deck

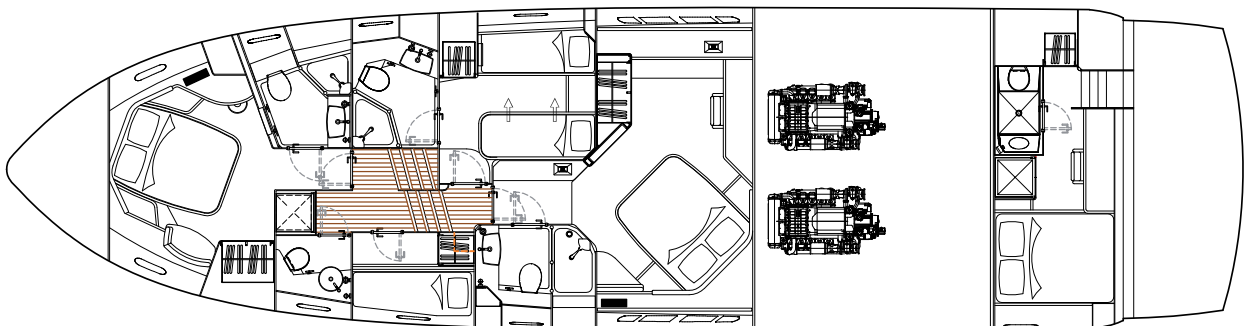

Lower Deck



Jones Bay wharf 19-21  
Suite 90, 26-32 Pirrama road  
Pyrmont NSW 2009

T: 02 9518 6977  
F: 02 9571 4377  
E: info@jwmarine.com.au

[www.jwmarine.com.au](http://www.jwmarine.com.au)